

# AMF

## MARK 75 BREAD BAGGER



*(Shown with Optional Lexan® Scoop Guard)*

- **Modular Concept for Reduced Production Downtime and Ease of Maintenance**
- **Interchangeable Parts for Left-Hand and Right-Hand Models**
- **Compact Design for Minimized Floor Space**
- **Advanced Drive Design to Handle High Speeds Up to 75 Loaves Per Minute**

### FEATURES & BENEFITS

- **Air operated wicket automatic changer with oversized magnetic cylinder allows wicket change without stopping the bagger**
- **Flusher discharge conveyor eliminates the need of a flusher bar and provides a smoother transfer**
- **Smooth, quiet and efficient operation is achieved by a belt drive system (no gearbox and clutch)**
- **High quality components to provide PLC with accurate information (position, speed, current bag detection) for control and monitoring**

### MECHANICAL FEATURES

- Speed range from 35 to 75 LPM
- 95% of symmetrical parts (right-hand or left-hand) for reduced spare parts inventory
- Scoop levers configuration allows top scoop to stay straight for more consistent bag friction and more consistent bag release
- Patented flusher discharge conveyor eliminates the need of a flusher bar and provides a smoother transfer (U.S. Patent 6,766,898)
- Air operated oversized magnetic cylinder allows automatic wicket change without stopping the bagger
- Tilting wicket tables for easy insertion of wickets and elimination of operator action when switching
- Shaft-driven conveyors
- In-motion scoop adjustment
- Adjustable Neoprene feet for easy installation
- Corrosion resistant stainless steel frame and guards
- Slotted stainless steel scoop guard with safety switches
- Computer assisted, pendulum style scoop drive for low vibration and optimal operations



Pendulum Scoop Drive



Flusher Discharge Conveyor



Automatic Dual Wicket Changer

### ELECTRICAL FEATURES

**NEMA 12 painted steel operator panel contains the following:**

- Allen Bradley PanelView 300 operator interface which displays:
  - Online timing adjustment
  - Status messages
  - Precise alarm messages
  - Loaf counter
  - Speed indicator
- Alarm beacon
- Allen Bradley push buttons for the following functions:
  - Start
  - Stop
  - Jog
  - Manual air blast
  - Alarm (acknowledge/reset)
  - Emergency stop



Operator Interface Panel

**NEMA 12 machine mount painted steel electrical enclosure including:**

- Main power disconnect
- Allen Bradley MicroLogix 1500 modular hardware programmable logic controller
- Allen Bradley Powerflex AC inverter (5 HP) with brake resistor
- Incremental encoder for scoop position
- Convenience plug installed on panel side to allow programming without having to open panel door

110V outlet and power for tyer and labeler

Sensor for bag detection

Double loaf detector

Safety switch on guards with individual alarm messages

Internal lighting

Recipe management for pre-programmed specifications for fast bagger set-up



## MECHANICAL OPTIONS

- Hook-up kit to Micro 75 Slicer
- Infeed conveyor phaser
- Extended 36" (914 mm) discharge conveyor
- Lexan® scoop guard in lieu of slotted stainless
- Skip loaf device
- Additional stainless steel scoop assemblies
- Bag tyer and printer
- Free roller pick off conveyor and tray support
- Twin and triple loaf secondary bagging systems



*Twin Loaf Bagging System*

## ELECTRICAL OPTIONS

- NEMA 12 stainless steel electrical enclosure and operator console
- Operator panel mounted on a pendant arm
- Missed bag sensor
- Allen Bradley PV 500/600 monochrome/color touchscreen operator interface in lieu of PV 300
- SLC 5/00 modular hardware programmable logic controller in lieu of MicroLogix 1500

## SPECIFICATIONS

**Throughput Range:**  
35 - 75 loaves per minute

**Electrical Requirements:**  
Main Power - 7 KVA  
PLC I/O Voltage - 24VDC in/120VAC out  
Air Requirements - 10 SCFM @ 80 PSIG

**Loaf Size Range:**  
Length: 8" (203 mm) 16" (406 mm)  
Width: 3-5/8" (98 mm) 5-1/2" (140 mm)  
Height: 3" (76 mm) - 6" (152 mm)

**Approximate Shipping Weight:**  
3,400 lb. (1542 kg)

**Approximate Shipping Dimensions:**  
104" x 127" x 60"  
(2642 mm x 3226 mm x 1524 mm)

### DIMENSIONAL DRAWING

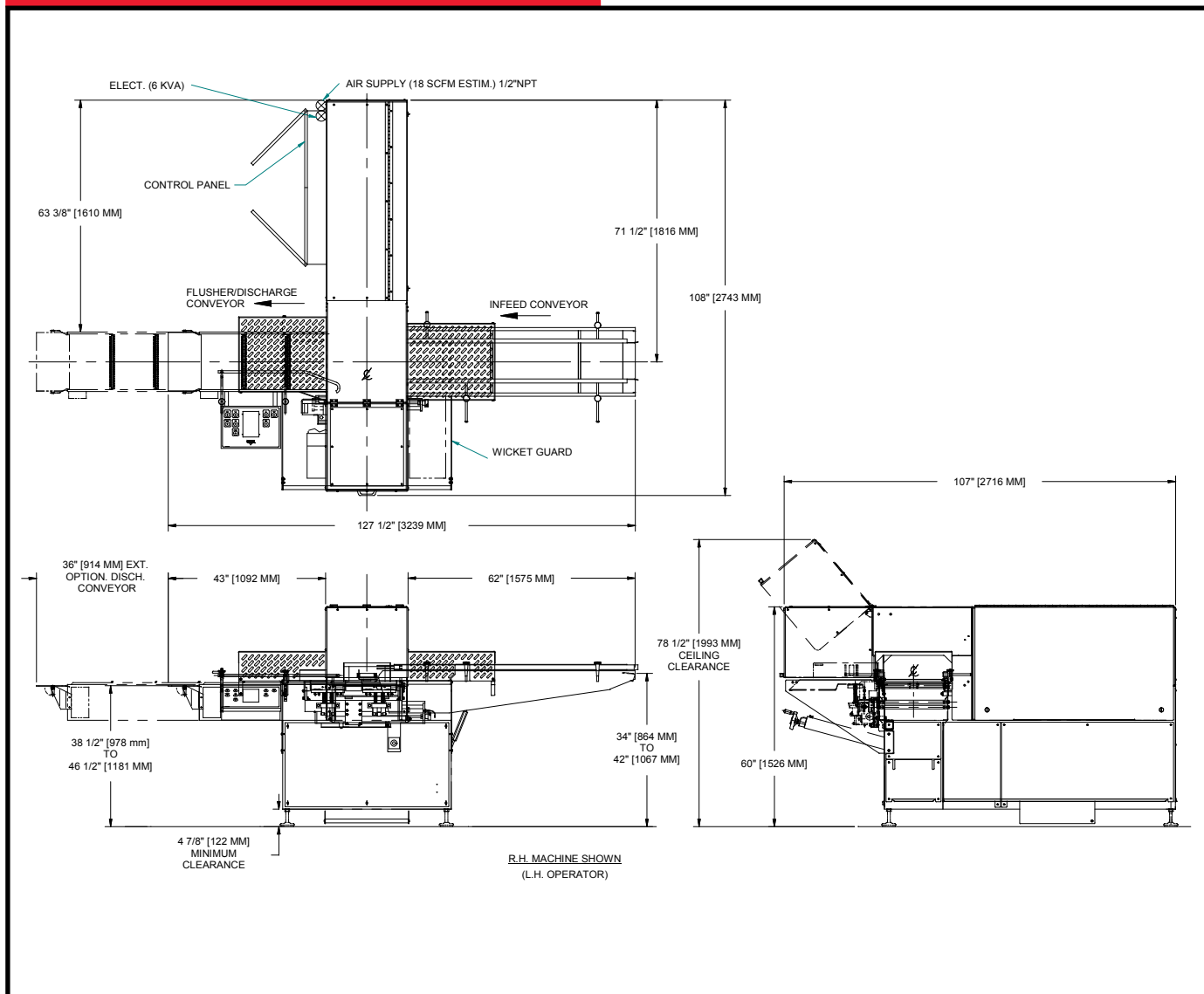

**Headquarters:**  
2115 W. Laburnum Ave.  
Richmond, Virginia 23227  
Tel: 1-800-225-3771  
or 1-804-355-7961  
Fax: 1-804-342-9724  
[sales@amfbakery.com](mailto:sales@amfbakery.com)

**Europe Office:**  
West Park Ring Road  
Leeds LS16 6QQ  
England  
Tel: 44-1132-787110  
Fax: 44-1132-741415  
[sales-europe@amfbakery.com](mailto:sales-europe@amfbakery.com)

**Asia Office:**  
Room 15-2, A-Building  
Thunis Dev. Building  
No.11 Hui Xin East St.  
Chaoyang District  
Beijing, China 100029  
Tel: 86-10-64823613  
Fax: 86-10-64934259  
[sales-asia@amfbakery.com](mailto:sales-asia@amfbakery.com)

FOR MORE INFORMATION PLEASE CALL YOUR ACCOUNT MANAGER OR

**1-800-BAKERS-1**  
**www.amfbakery.com**

AMF's focus on continuous improvement may result in changes to machinery specifications without notice.